

MCG 1010M Magnetostrictive Receiver

Multi-Purpose

The MCG 1010M Receiver harnesses the impressive accuracy and resolution of the MCG 1030 or MCG 8150 series Magnetostrictive Probes to provide continuous level measurement and local access to the data. The MCG 1010M is designed to provide reliable, low maintenance operation under even the most adverse of conditions. With a graphical LCD readout and infrared programming capabilities as standard features, the unit can be utilized as stand-alone gauge or be integrated as part of a complete gauging system.

Compatibility

Like all L&J Gauges, the MCG 1010M communicates on the standard L&J Tankway. Intelligent modules to emulate nearly any other protocol or highway are also available and easily interchangeable. The unit may also be configured to accommodate temperature inputs (Spot or Average), relays (up to 4), 4-20mA inputs or outputs (up to 2), and discrete inputs or outputs (4). In addition to a level probe, the MCG 1010M accepts input from various L&J leak detection sensors (vapor and/or liquid). When used as a part of a multiple unit system, each receiver can be calibrated and configured for any or all of the available options.

Convenient

Calibration can be accomplished via the MCG 2150 Remote Calibrator; eliminating the need to remove the cover from the gauge housing. Current level, temperature, volume, and bottom/sediment, or pressure information is easily accessible, right at the tank side. System configuration and parameters can also be continued from a MCG 3000 Series Gauging System. Comprehensive surge and lightning protection is also an integral part of the unit.



Features

- High Accuracy, Continuous Online Measurement
- Supports Spot or Average Temperature
- Supports Dual 4-20mA Inputs & Outputs
- Local Graphical LCD Display
- Handheld Infrared Calibration
- Economical

Applications

The MCG 1010M can be combined with a magnetostrictive probe as a stand-alone gauge or as part of a complete system.

The MCG 1010M is suitable for use in the following industries:

Petroleum	Petrochemical	Chemical
Food & Beverage	Water Treatment	Pharmaceutical

Specifications:

Resolution:

.001" (with MCG 8150 Series Probe)

Housing:

Material:

Aluminum (standard)

Rating:

Explosion Proof, Class I, Div. 1 Groups C&D

Display:

Graphical LCD backlit display

Communication:

L&J Tankway (standard), other protocols available

Calibration Method:

MCG 2150 Remote Calibrator (Intrinsically Safe)

Operating Temp. Range:

-30° to +160° F

SCADA Options:

2 Analog (4-20mA, 10-50mA Inputs)

2 Analog (4-20mA, 10-50mA Outputs)

2 Pulses (from Turbine Flow Meters)

4 Discrete Inputs

4 Discrete Outputs

Power Sources:

220VAC, 110VAC, 65VAC, 48VAC 24VAC, 48VDC, 24VDC

Cable Length Local Readout to Probe:

Up to 1000 Feet (305 m)

Local Readout to control room:

Up to 10 Miles (16093 m)

Dimensions

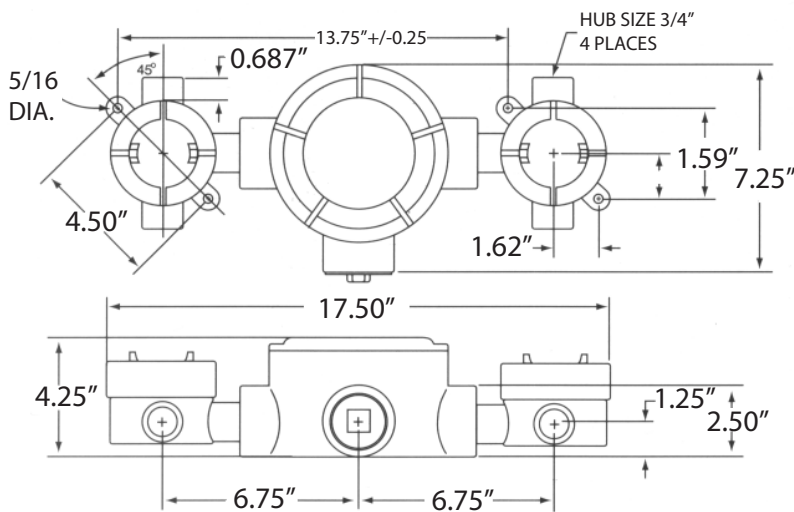

Typical System Layout

MCG 1030, 8150B, 8151 8190A
Magnetostrictive Probe

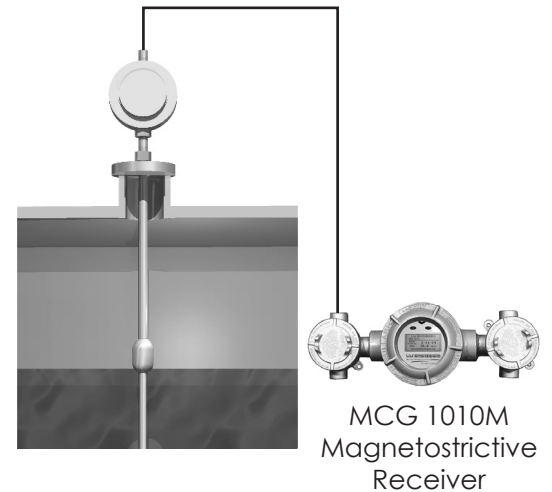

All designs subject to change. Certified dimensions and specifications available upon request.